

# Kiosk

**K27**

## Intelligent Self-checkout Ordering Kiosk

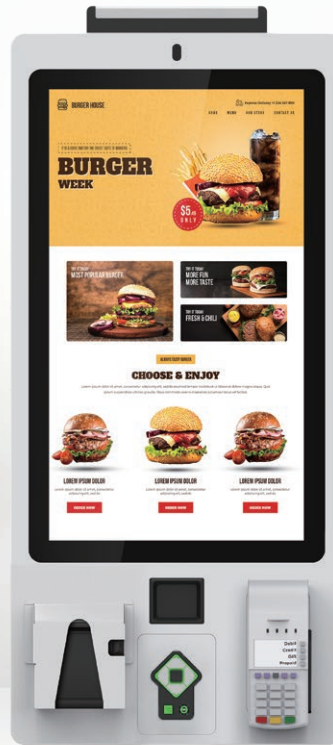

### FEATURES

- 27" capacitive touch screen
- Screen resolution 1920 x 1080
- Fanless design, high performance Intel CPU, with high speed M.2 SATA SSD
- Modular design, easy to maintain
- Can integrate various peripheral equipment
- Provide flexibility to expand components and upgrades
- Color, shape and appearance customization service

# Kiosk



## For an optimized workflow

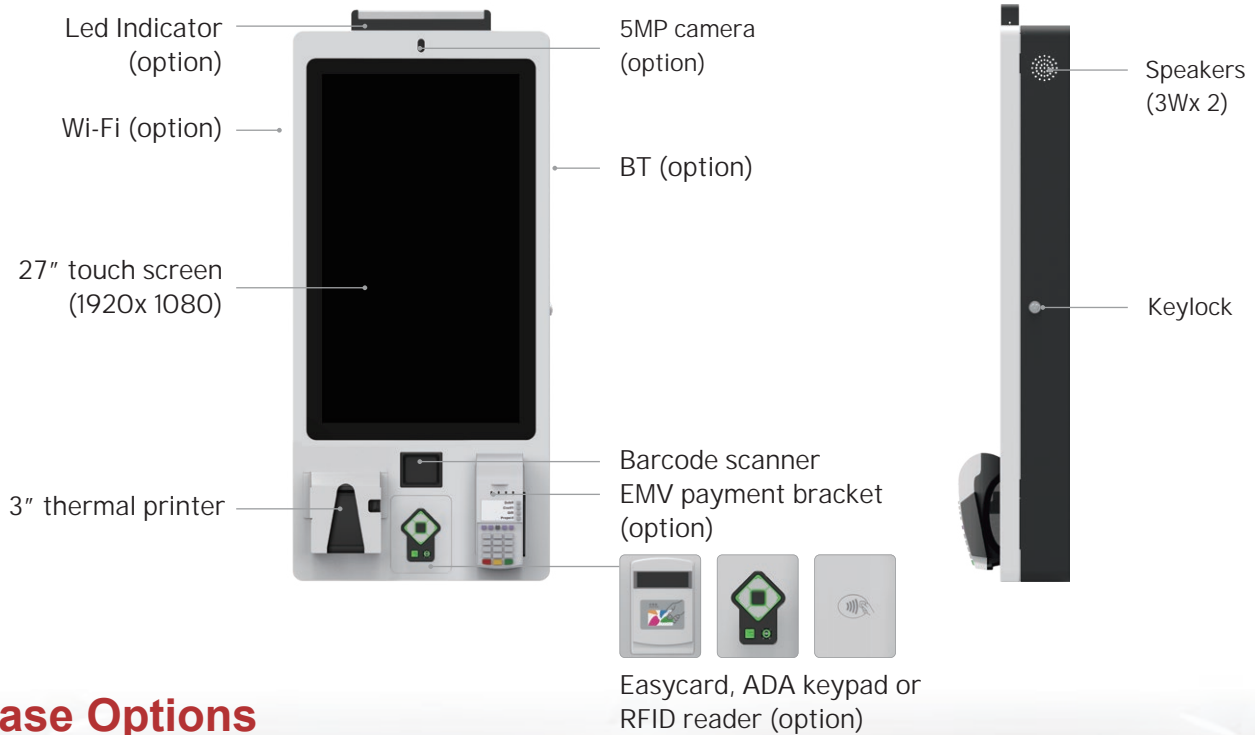

## Base Options



# Kiosk

**PARTNER**

## Specifications



Item	K27			
Display	27", 16:9 , 1920 x 1080, 300 nits 27", 16:9 , 1920 x 1080, 650 nits (option)			
Touch	PCAP Touch			
CPU	<b>Alder Lake-P</b> Intel® Celeron® 7305 Intel® Core™ i3-1215U Intel® Core™ i5-1245U, vPro Intel® Core™ i7-1265U, vPro	<b>Elkhart Lake</b> Intel® Celeron® J6412	<b>Kaby Lake-U</b> Intel® Core™ i3-7100U Intel® Core™ i5-7300U	<b>Rockchip RK3399</b>
Memory	DDR4 4GB, 8GB, 16GB, 32G			LDDR4 4GB
Storage	M.2 PCIe SSD: 128G / 256G / 512G			eMMC 32GB + 1x micro SD card slot (up to 128GB)
I/O Interface	1 x Gigabit Ethernet 1 x AC male power socket 1 x power switch button			
Speakers	2 x speaker (3W)			
Printer	3" thermal printer			
Peripheral Options	2D barcode scanner EMV terminal bracket 5MP camera RFID / NFC reader ADA keypad Floor stand (including wheels & handle) VESA wallmount bracket			
Wi-Fi / BT (option)	Wi-Fi 6E Intel AX210, IEEE 802.11 a/b/g/n/acR2/axR2, BT 5.2			2.4GHz/5GHz (IEEE 802.11a/b/g/n/ac), BT 4.2 (supports BLE)
Operating System	1. Windows 11 IoT Enterprise GAC (64bit) ready 2. Windows 10 IoT Enterprise LTSC 21H2 (64bit) 3. Linux Ubuntu 22.04		1. Windows 10 IoT Enterprise LTSC 21H2 (64bit) 2. Linux Ubuntu 18.04	Android 11
TPM & vPro	1. Intel vPro (i5/i7 CPU only) 2. S/W TPM 2.0 (BIOS)	S/W TPM 2.0 (BIOS)	1. Intel vPro (i5 CPU only) 2. S/W TPM 2.0 (BIOS)	N/A
Power Supply	AC-In 100~240V / DC-Out 12V, 120W			AC-In 100~240V / DC-Out 12V, 90W
Reliability	System operating temperature: 0~40°C / 32~104°F System humidity: 15% ~ 80% Storage temperature: -20~60°C / -4~140°F			
Dimensions (Wx Hx D)	Wall mount: 450 x 963 x 120 mm / 17.72 x 37.91 x 4.72 in Floor stand: 550 x 1900 x 610 mm / 21.65 x 74.80 x 24.02 in			
Weight	Wall mount: 30Kg / 66.14 lbs Floor stand: 64 Kg / 141.11 lbs			

\*Specification is subject to change without prior notice

## Contact Now

**TAIWAN** E-mail:sales@partner.com.tw  
**USA** E-mail:sales@partnertechcorp.com  
**EUROPE** E-mail:info@partner-tech.eu  
**UK** E-mail:sales@partnertechuk.com  
**CHINA** E-mail:sales@partnertech.com.cn

**MIDDLE EAST** E-mail:info@partnertechme.com  
**AUSTRALIA** E-mail:sales@partner-tech.com.au  
**SOUTH EAST ASIA** E-mail:ptse@partner.com.tw  
**JAPAN** E-mail:sales-jp@partner.com.tw

